

# PRECISION

IN SINTERED MATERIALS

# ENDTER

**ENDTER**  
SINTERTECHNIK





## COMPANY

Endter Sintertechnik GmbH & Co. KG was established in 1958 by Harry Endter. The precision manufacturing that grew from these roots continues today with the production of large quantities of precision parts in sintered materials. More than 180 skilled workers manufacture ready-to-install components and component kits at two industrial premises with more than 5,000 square metres of production area.

Those components are used in the automobile industry around the world and system suppliers and car manufacturers that are supplied with millions of units per year are among our company's most important customers.



Our size, structure and organisation allow us to successfully supply customers who

require small quantities that are at the borderline of economic efficiency in sinter technology.

The name Endter is synonymous with construction kits of the highest quality, regardless of whether you require sintered steel, engineering ceramics, PM composite or high-performance materials.



## KEY SERVICES

-  **MANUFACTURING TOOLS FOR SINTER TECHNOLOGY**
-  **FINISHING SINTERED MOULDINGS TO MAKE READY-TO-INSTALL PRECISION PARTS**
-  **MANUFACTURING SINTERED PRECISION CONSTRUCTION KITS IN HARD-WEARING COMBINATIONS OF MATERIALS**

# WE HELP YOU TO ACHIEVE YOUR GOALS

## REQUIREMENTS

As specialists in the sinter technology sector we will address your individual requirements. We plan and realise all the necessary processes – from material selection through to the finished product.



## CONSTRUCTION

We use the latest software to develop and construct precision workpieces as well as the necessary corresponding tools.

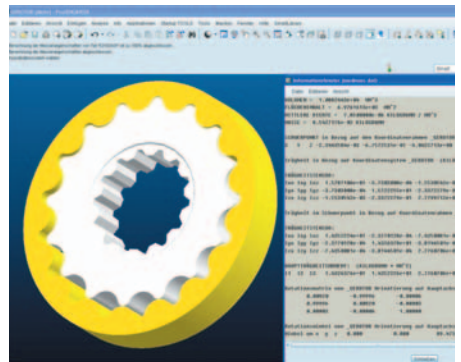

We specialise in gear wheels, gerotors, rotors and the corresponding construction kit parts.

## PRODUCTION

Endter sinter technology can guarantee quality and reliability, even for difficult requirements, because of our many years of experience and our use of precision technology.

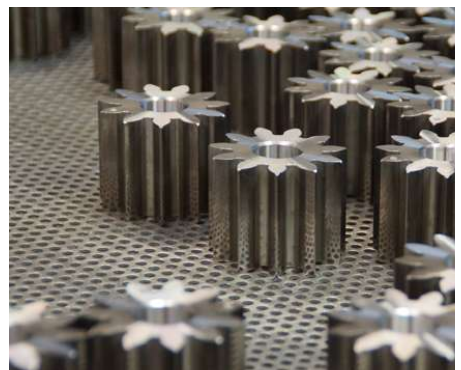

## QUALITY CONTROL

We rely on the highest quality standards that allow us to always satisfy the highest technical requirements in today's automobile industry.

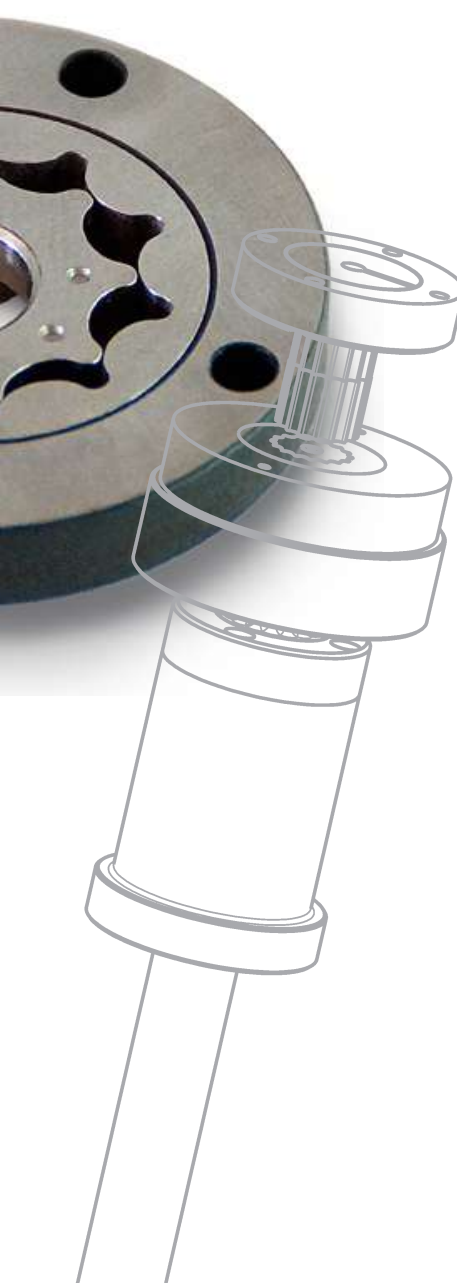



# SPUR WHEELS FOR OIL PUMPS



Motor vehicle oil pumps for everything from the smallest car to a high-performance truck engine



Wheel set to supply the transmission, with liner on the loose gear for challenging pumping mediums and high pumping pressure

## OUR SPUR WHEELS ARE CHARACTERISED BY THEIR:

- Profile accuracy
- Precision in form and dimensions
- Roll quality
- Surface quality
- Compression and strain hardening of the tooth flanks
- Root strength and load capacity of the tooth flanks
- Low noise levels
- Specific tooth forms

# GEROTORS AS GEAR PAIR OR CONSTRUCTION KIT



Abrasion resistant, hard material  
coated outer rotor

Quench hardened inner rotor with  
hard-wearing spline shaft drive



Gerotor set in nitro-carburised sintered steel,  
spacer ring with hardwearing, oxidised tread



Gerotor set in alloyed sintered steel with  
inner rotor – coupling

## OUR GEROTORS ARE CHARACTERISED BY THEIR:

- Long service life
- Low gap losses
- Adapted toothing form
- Required flow volume
- Low modulation noise
- Hardwearing materials

# MOULDED PARTS

Rotor and stroke ring for variable oil pumps

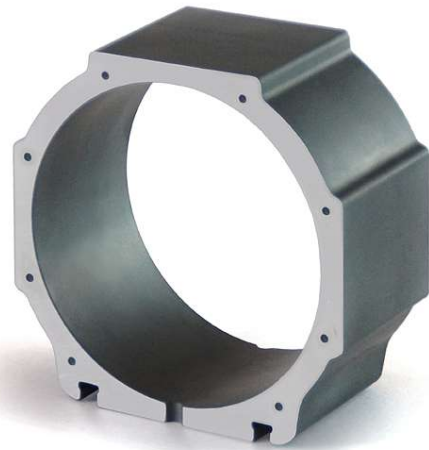

Quench hardened slide-seal elements for vane vacuum pumps

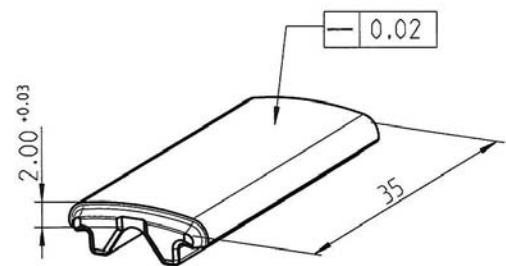

Axial sealing disks for gerotor pumps in engineering ceramics

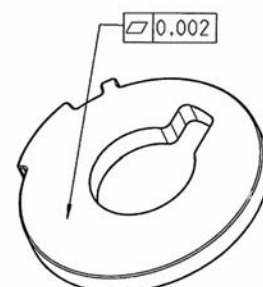





Raw part production



Heat treatment

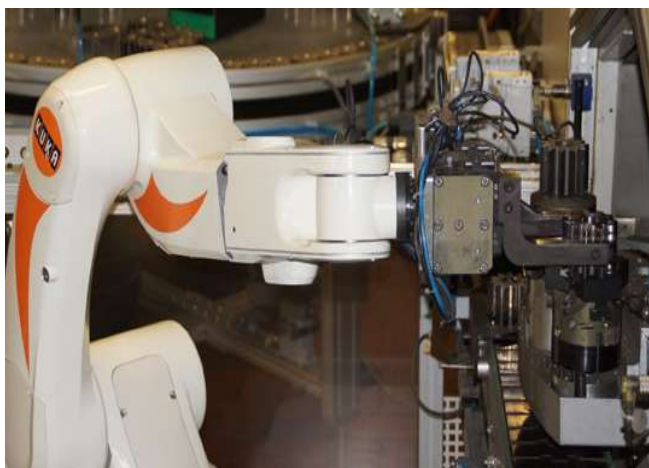

Robot precision production

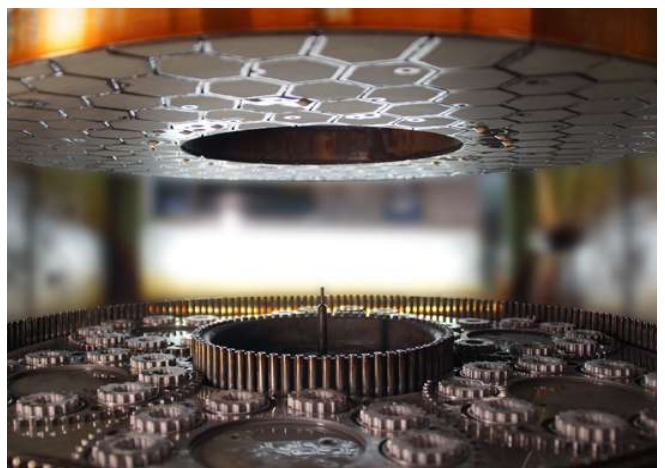

Precision grinding technology

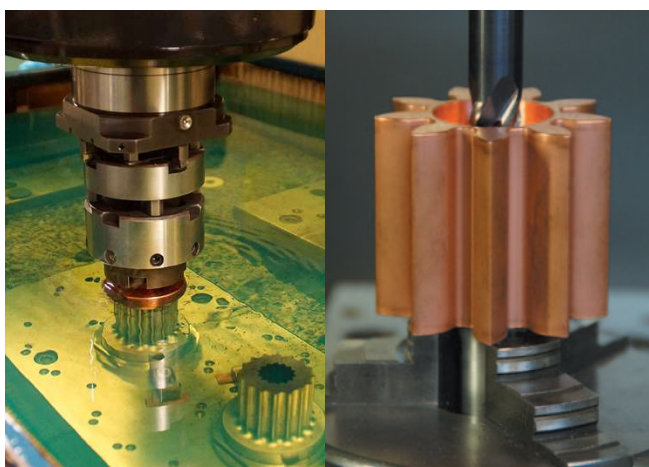

Tool manufacture

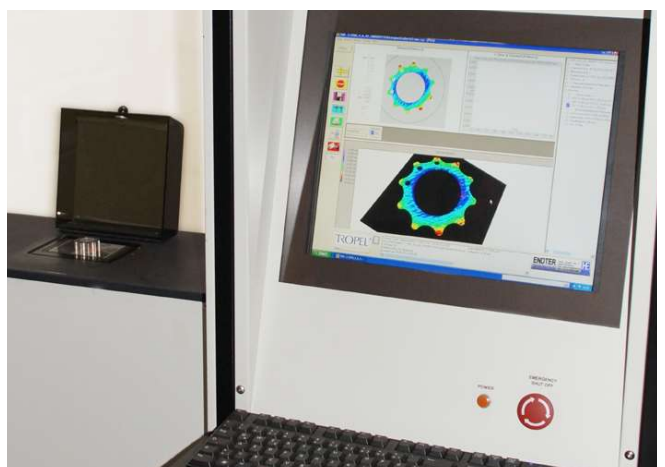

Quality assurance



Endter Sintertechnik GmbH & Co. KG  
 Harry-Endter-Straße 1  
 54570 Densborn  
 Germany  
 Tel.: +49 (0) 65 94/9201-0  
 Fax: +49 (0) 65 94/1689

info@endter-sintertechnik.com  
 www.endter-sintertechnik.com

